

Robust & Durable End Shield AC Motors

Advantages

This special design without a housing features high peak powers and an optimum price-to-performance ratio. Typical uses are applications with high peak loads and low continuous outputs, e.g. **traction motors** (stop & go operation) and **hydraulic pumps** (power on demand) in battery-operated vehicles. External drive controllers assume the power supply and the speed / torque control.

- High peak torque
- Compact design
- Various options available



Technical Data

Frame Size	80	90	100	112	132	160
Output S2-60 min @ 4500 RPM (traction) [kW]	1.6	2.2	3.3	5.6	10.5	18
Output S3-15% @ 2500 RPM (pumping) [kW]	1.8	3.9	7.1	12.5	22	30
Torque S2-5 min [Nm]	10	18	28	90	160	260
Peak torque [Nm]	12.5	24	65	140	180	300
Battery voltage [VDC]	24	48		72		80
Max. output speed [RPM]	6000		7250		7000	6000
Protection Class	IP54 (connections IP00)					

Data are typical size-dependent values for non-cooled motors with different overall stack lengths. Additional detailed information and characteristic curves available upon request.

Special Features

- Application-specific **winding design**
- Temperature monitoring via **PT1000 temperature sensor**
- **Motor speed recording** via incremental encoder with up to 64 pulses per revolution

Options

- **Flange and output shaft** for customer-specific gearbox interfaces
- Higher **maximum speeds / torques** available upon request
- Electromechanical **holding brake**
- **UL version**

Dimension Table

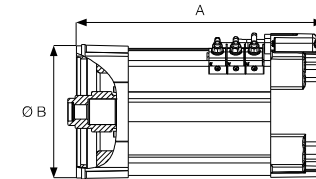

Frame Size	80	90	100	112	132	160
Length A [mm]	165 – 225	185 – 270	205 – 300	255 – 335	300 – 420	320 – 420
Diameter B [mm]	120	138	155	175	215	310
Weight [kg]	8 – 12	14 – 20	22 – 30	31 – 40	54 – 70	92 – 110

All dimensions and weights are estimates and for reference only.

Application Examples

- **Traction motors** for electric vehicles, industrial trucks, aerial work platforms, scooters, golf carts, construction and agricultural machinery and much more
- **Boat drives** (e.g. propulsion and bow thruster)
- **Auxiliary units** in trucks, buses and work machinery (e.g. hydraulic pumps, compressors and blowers)

